

Product Specificaties	
Max werkdruk cilinder (Bar)	210
Max snelheid cilinder (m/s)	0,5
Temperatuur afdichtingen (°C)	-25 / +80

HMB

Dubbelwerkende Cilinder

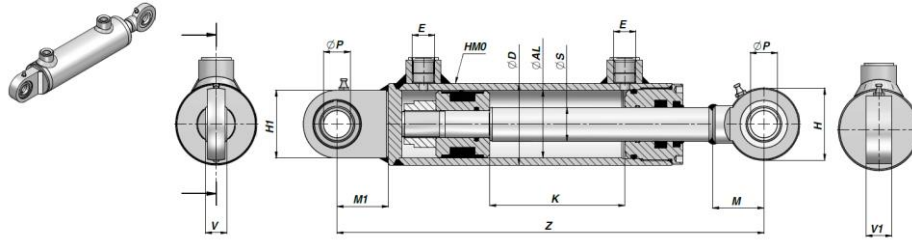

Artikelnummer	Ø D	Ø AL	Ø S	K Slag	Z	Kg	E BSP	Ø P	H	V	M	H1	V1	M1
HMB032200050	42	32	20	50	225	1,75	1/4"	16	46	14	35	48	17,5	35
HMB032200100				100	275	2,09								
HMB032200150				150	325	2,44								
HMB032200200				200	375	2,79								
HMB032200250				250	425	3,15								
HMB032200300				300	475	3,49								
HMB032200400				400	575	4,19								
HMB032200500				500	675	4,90								
HMB1200100	50	40	20	100	300	2,75	1/4"	16	46	14	35	48	17,5	35
HMB1200150				150	350	3,15								
HMB1200200				200	400	3,55								
HMB1200250				250	450	3,96								
HMB1200300				300	500	4,35								
HMB1200350				350	550	4,75								
HMB1200400				400	600	5,15								
HMB1200450				450	650	5,55								
HMB1200500	500	700	5,95											
HMB1250100	50	40	25	100	300	2,94	1/4"	16	46	14	35	48	17,5	35
HMB1250150				150	350	3,41								
HMB1250200				200	400	3,89								
HMB1250250				250	450	4,34								
HMB1250300				300	500	4,81								
HMB1250350				350	550	5,28								
HMB1250400				400	600	5,75								
HMB1250450				450	650	6,22								
HMB1250500	500	700	6,68											
HMB1250550	550	750	7,16											
HMB1250600	600	800	7,62											
HMB2250100	60	50	25	100	316	3,91	3/8"	20	53	16	38	50	19	38
HMB2250150				150	366	4,43								
HMB2250200				200	416	4,96								
HMB2250250				250	466	5,49								
HMB2250300				300	516	6,02								
HMB2250350				350	566	6,55								
HMB2250400				400	616	7,08								
HMB2250450				450	666	7,61								
HMB2250500				500	716	8,14								
HMB2250550				550	766	8,67								
HMB2250600				600	816	9,20								
HMB2250700				700	916	10,26								
HMB2250800				800	1016	11,32								
HMB2251000				1000	1216	13,44								
HMB2300100	60	50	30	100	316	4,11	3/8"	20	53	16	38	50	19	38
HMB2300150				150	366	4,73								
HMB2300200				200	416	5,34								
HMB2300250				250	466	5,96								
HMB2300300				300	516	6,58								
HMB2300350				350	566	7,20								
HMB2300400				400	616	7,80								
HMB2300450				450	666	8,42								
HMB2300500				500	716	9,04								
HMB2300550				550	766	9,64								
HMB2300600				600	816	10,27								
HMB2300700				700	916	11,50								
HMB2300800				800	1016	12,72								
HMB2301000				1000	1216	15,18								
HMB3300100	70	60	30	100	350	5,88	3/8"	25	64	20	45	55	23	45
HMB3300150				150	400	6,56								
HMB3300200				200	450	7,23								
HMB3300250				250	500	7,91								
HMB3300300				300	550	8,59								
HMB3300350				350	600	9,26								
HMB3300400				400	650	9,93								
HMB3300450				450	700	10,61								
HMB3300500				500	750	11,29								
HMB3300550				550	800	11,96								
HMB3300600				600	850	12,64								
HMB3300700				700	950	14,00								
HMB3300800				800	1050	15,34								
HMB3301000				1000	1250	18,04								

Product Specificaties	
Max werkdruk cilinder (Bar)	210
Max snelheid cilinder (m/s)	0,5
Temperatuur afdichtingen (°C)	-25 / +80

HMB

Dubbelwerkende Cilinder

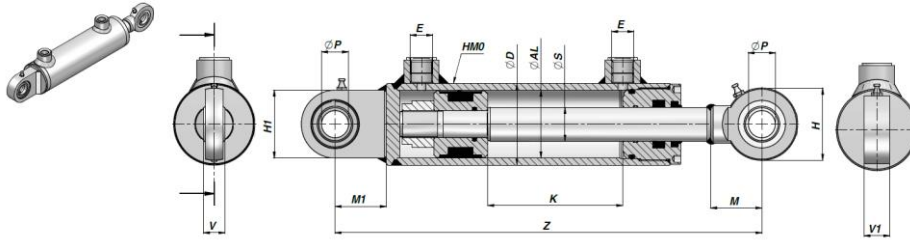

Artikelnummer	Ø D	Ø AL	Ø S	K Slag	Z	Kg	E BSP	Ø P	H	V	M	H1	V1	M1											
HMB3300100	70	60	35	100	350	6,12	3/8"	25	64	20	45	55	23	45											
HMB3300150				150	400	6,90																			
HMB3300200				200	450	7,68																			
HMB3300250				250	500	8,45																			
HMB3300300				300	550	9,22																			
HMB3300350				350	600	10,00																			
HMB3300400				400	650	10,78																			
HMB3300450				450	700	10,62																			
HMB3300500				500	750	12,33																			
HMB3300550				550	800	13,10																			
HMB3300600				600	850	13,88																			
HMB3300700				700	950	15,44																			
HMB3300800				800	1050	16,99																			
HMB3301000				1000	1250	20,09																			
HMB3400200	70	60	40	200	450	8,35	3/8"	25	64	20	45	55	23	45											
HMB3400250				250	500	9,19																			
HMB3400300				300	550	10,11																			
HMB3400350				350	600	10,99																			
HMB3400400				400	650	11,86																			
HMB3400450				450	700	12,78																			
HMB3400500				500	750	13,67																			
HMB3400550				550	800	14,56																			
HMB3400600				600	850	15,45																			
HMB3400700				700	950	17,24																			
HMB3400800				800	1050	19,02																			
HMB3401000				1000	1250	22,58																			
HMB063400200				73	63	40									200	450	8,52	3/8"	25	64	20	45	55	23	45
HMB063400250															250	500	9,53								
HMB063400300	300	550	10,36																						
HMB063400350	350	600	11,27																						
HMB063400400	400	650	12,16																						
HMB063400450	450	700	13,07																						
HMB063400500	500	750	13,98																						
HMB063400550	550	800	14,89																						
HMB063400600	600	850	15,80																						
HMB063400700	700	950	17,64																						
HMB063400800	800	1050	19,46																						
HMB063401000	1000	1250	23,08																						
HMB4350100	80	70	35				100	350	7,12	3/8"	25	64	20	45	55	23	45								
HMB4350150							150	400	7,93																
HMB4350200				200	450	8,79																			
HMB4350250				250	500	9,61																			
HMB4350300				300	550	10,47																			
HMB4350350				350	600	11,00																			
HMB4350400				400	650	12,14																			
HMB4350450				450	700	12,98																			
HMB4350500				500	750	13,79																			
HMB4350550				550	800	14,63																			
HMB4350600				600	850	15,49																			
HMB4350700				700	950	17,15																			
HMB4350800				800	1050	18,81																			
HMB4351000				1000	1250	22,17																			
HMB4400100	80	70	40	100	350	7,48	3/8"	25	64	20	45	55	23	45											
HMB4400150				150	400	8,44																			
HMB4400200				200	450	9,40																			
HMB4400250				250	500	10,35																			
HMB4400300				300	550	11,31																			
HMB4400350				350	600	12,24																			
HMB4400400				400	650	13,19																			
HMB4400450				450	700	14,16																			
HMB4400500				500	750	15,11																			
HMB4400550				550	800	16,05																			
HMB4400600				600	850	17,00																			
HMB4400700				700	950	18,92																			
HMB4400800				800	1050	20,81																			
HMB4401000				1000	1250	24,62																			

HMB

Dubbelwerkende Cilinder

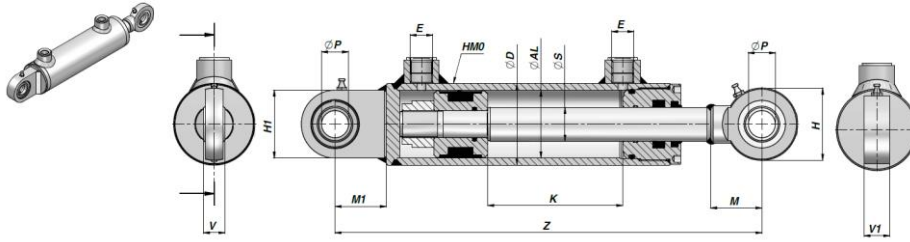

Artikelnummer	Ø D	Ø AL	Ø S	K Slag	Z	Kg	E BSP	Ø P	H	V	M	H1	V1	M1
HMB5400200	92	80	40	200	482	12,81	1/2"	30	73	22	51	65	28	51
HMB5400250				250	532	13,93								
HMB5400300				300	582	15,05								
HMB5400400				400	682	17,24								
HMB5400500				500	782	19,55								
HMB5400600				600	882	21,80								
HMB5400700				700	982	24,05								
HMB5400800				800	1082	26,30								
HMB5401000				1000	1282	30,80								
HMB5500200	92	80	50	200	482	13,98	1/2"	30	73	22	51	65	28	51
HMB5500250				250	532	15,47								
HMB5500300				300	582	16,87								
HMB5500400				400	682	19,59								
HMB5500500				500	782	22,43								
HMB5500600				600	882	25,29								
HMB5500700				700	982	28,10								
HMB5500800				800	1082	30,90								
HMB5501000				1000	1282	36,47								
HMB090500300	105	90	50	300	624	23,14	1/2"	40	92	28	69	100	35	69
HMB090500400				400	724	26,47								
HMB090500500				500	824	29,80								
HMB090500600				600	924	33,14								
HMB090500700				700	1024	36,47								
HMB090500800				800	1124	39,80								
HMB090501000				1000	1324	46,52								
HMB6500200	115	100	50	200	548	23,46	1/2"	40	92	28	69	100	35	69
HMB6500250				250	598	25,22								
HMB6500300				300	648	26,97								
HMB6500400				400	748	30,49								
HMB6500500				500	848	34,00								
HMB6500600				600	948	37,53								
HMB6500700				700	1048	41,05								
HMB6500800				800	1148	44,56								
HMB6501000				1000	1348	51,59								
HMB6600300	115	100	60	300	648	29,17	1/2"	40	92	28	69	100	35	69
HMB6600400				400	748	33,36								
HMB6600500				500	848	37,56								
HMB6600600				600	948	41,76								
HMB6600700				700	1048	45,95								
HMB6600800				800	1148	50,15								
HMB6601000	1000	1348	58,62											