

## HMO Dubbelwerkende Cilinder

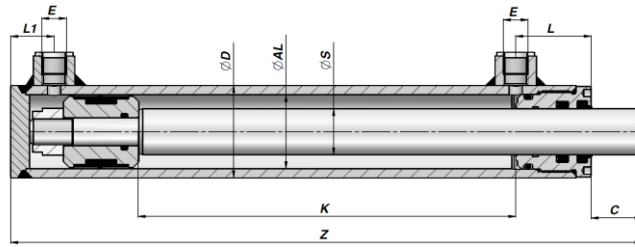

Artikelnummer	Ø D	Ø AL	Ø S	K Slag	Z	Kg	E BSP	L	L1	C
26.025160050	35	25	16	50	135	0,71	1/4"	33	15	17
26.025160100				100	185	0,97				
26.025160150				150	235	1,23				
26.025160200				200	285	1,50				
26.032200050	42	32	20	50	155	1,27	1/4"	33	20	16
26.032200100				100	205	1,62				
26.032200150				150	255	1,97				
26.032200200				200	305	2,33				
26.032200250				250	355	2,68				
26.032200300				300	405	3,03				
26.032200400				400	505	3,73				
26.032200500				500	605	4,42				
26.040200100	50	40	20	100	230	2,29	1/4"	40	23	22
26.040200150				150	280	2,69				
26.040200200				200	330	3,09				
26.040200250				250	380	3,49				
26.040200300				300	430	3,83				
26.040200350				350	480	4,29				
26.040200400				400	530	4,69				
26.040200450				450	580	5,08				
26.040200500	500	630	5,49							
26.040250100	50	40	25	100	230	2,45	1/4"	40	23	22
26.040250150				150	280	2,92				
26.040250200				200	330	3,40				
26.040250250				250	380	3,86				
26.040250300				300	430	4,33				
26.040250350				350	480	4,80				
26.040250400				400	530	5,27				
26.040250450				450	580	5,74				
26.040250500				500	630	6,21				
26.040250550				550	680	6,68				
26.040250600				600	730	7,14				
26.040250650				650	780					
26.040250700				700	830					
26.040250750				750	880					
26.040250800				800	930					
26.040250850				850	980					
26.040250900				900	1030					
26.040250950				950	1080					
26.040251000				1000	1130					
26.040251100				1100	1230					
26.040251200	1200	1330								
26.040251250	1250	1380								
26.040251400	1400	1530								
26.040251500	1500	1630								
26.040251600	1600	1730								
26.040252000	2000	2130								
26.050250100	60	50	25	100	240	3,30	3/8"	43	26	22
26.050250150				150	290	3,83				
26.050250200				200	340	4,36				
26.050250250				250	390	4,89				
26.050250300				300	440	5,42				
26.050250350				350	490	5,95				
26.050250400				400	540	6,48				
26.050250450				450	590	7,01				
26.050250500				500	640	7,54				
26.050250550				550	690	8,07				
26.050250600				600	740	8,60				
26.050250700				700	840	9,66				
26.050250800				800	940	10,72				
26.050251000				1000	1140	12,83				

## HMO Dubbelwerkende Cilinder

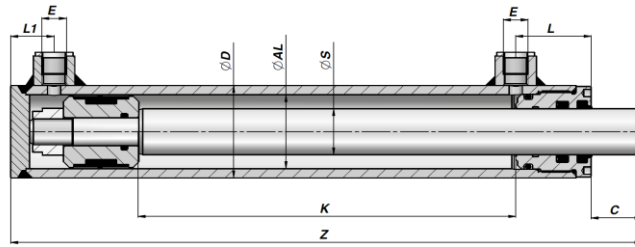

Artikelnummer	Ø D	Ø AL	Ø S	K Slag	Z	Kg	E BSP	L	L1	C
26.050300100	60	50	30	100	240	3,51	3/8"	43	26	22
26.050300150				150	290	4,12				
26.050300200				200	340	4,70				
26.050300250				250	390	5,40				
26.050300300				300	440	6,00				
26.050300350				350	490	6,60				
26.050300400				400	540	7,20				
26.050300450				450	590	7,81				
26.050300500				500	640	8,42				
26.050300550				550	690	9,00				
26.050300600				600	740	9,70				
26.050300650				650	790					
26.050300700				700	840	10,90				
26.050300750				750	890					
26.050300800				800	940	12,10				
26.050300850				850	990					
26.050300900				900	1040					
26.050300950				950	1090					
26.050301000				1000	1140	14,60				
26.050301100				1100	1240					
26.050301200	1200	1340								
26.050301250	1250	1390								
26.050301400	1400	1540								
26.050301500	1500	1640								
26.050301600	1600	1740								
26.060300100	70	60	30	100	260	4,90	3/8"	50	30	23
26.060300150				150	310	5,60				
26.060300200				200	360	6,20				
26.060300250				250	410	6,90				
26.060300300				300	460	7,60				
26.060300350				350	510	8,30				
26.060300400				400	560	8,90				
26.060300450				450	610	9,60				
26.060300500				500	660	10,30				
26.060300550				550	710	11,00				
26.060300600				600	760	11,60				
26.060300700				700	860	12,99				
26.060300800				800	960	14,30				
26.060301000				1000	1160	17,00				
26.060350100				70	60	35				
26.060350150	150	310	5,90							
26.060350200	200	360	6,70							
26.060350250	250	410	7,50							
26.060350300	300	460	8,20							
26.060350350	350	510	9,00							
26.060350400	400	560	9,80							
26.060350450	450	610	10,60							
26.060350500	500	660	11,30							
26.060350550	550	710	12,10							
26.060350600	600	760	12,90							
26.060350700	700	860	14,44							
26.060350800	800	960	16,00							
26.060351000	1000	1160	19,10							
26.060351250	1250	1410								
26.060400100	70	60	40	100	260		3/8"	50	30	23
26.060400200				200	360	7,30				
26.060400250				250	410	8,20				
26.060400300				300	460	9,10				
26.060400350				350	510	10,00				
26.060400400				400	560	10,90				
26.060400450				450	610	11,80				
26.060400500				500	660	12,70				
26.060400550				550	710	13,60				
26.060400600				600	760	14,40				
26.060400700				700	860	16,23				
26.060400800				800	960	18,00				
26.060401000				1000	1160	21,60				
26.060401400				1400	1560					

## HMO Dubbelwerkende Cilinder

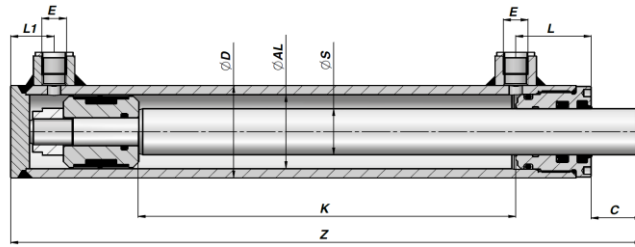

Artikelnummer	Ø D	Ø AL	Ø S	K Slag	Z	Kg	E BSP	L	L1	C
26.063400200	73	63	40	200	360	7,50	3/8"	50	30	23
26.063400250				250	410	8,40				
26.063400300				300	460	9,30				
26.063400350				350	510	10,30				
26.063400400				400	560	11,20				
26.063400450				450	610	12,10				
26.063400500				500	660	13,00				
26.063400550				550	710	13,90				
26.063400600				600	760	14,80				
26.063400800				800	960	18,40				
26.063401000				1000	1160	22,10				
26.070350100	80	70	35	100	260	6,10	3/8"	50	33	23
26.070350150				150	310	6,90				
26.070350200				200	360	7,80				
26.070350250				250	410	8,60				
26.070350300				300	460	9,40				
26.070350350				350	510	10,30				
26.070350400				400	560	11,10				
26.070350450				450	610	12,00				
26.070350500				500	660	12,80				
26.070350550				550	710	13,60				
26.070350600				600	760	14,50				
26.070350700	700	860	16,15							
26.070350800	800	960	17,80							
26.070351000	1000	1160	21,20							
26.070400100	80	70	40	100	260	6,48	3/8"	50	33	23
26.070400150				150	310	7,43				
26.070400200				200	360	8,40				
26.070400250				250	410	9,30				
26.070400300				300	460	10,30				
26.070400350				350	510	11,20				
26.070400400				400	560	12,20				
26.070400450				450	610	13,10				
26.070400500				500	660	14,10				
26.070400550				550	710	15,10				
26.070400600				600	760	15,99				
26.070400700	700	860	17,91							
26.070400800	800	960	19,80							
26.070401000	1000	1160	23,60							
26.080400200	92	80	40	200	380	11,22	1/2"	60	35	25
26.080400250				250	430	12,34				
26.080400300				300	480	13,46				
26.080400400				400	580	15,72				
26.080400500				500	680	17,77				
26.080400600				600	780	20,22				
26.080400700				700	880	22,47				
26.080400800				800	980	24,72				
26.080401000				1000	1180	29,22				
26.080500200				92	80	50				
26.080500250	250	430	13,88							
26.080500300	300	480	15,28							
26.080500400	400	580	18,09							
26.080500500	500	680	20,90							
26.080500600	600	780	23,70							
26.080500700	700	880	26,50							
26.080500800	800	980	29,50							
26.080501000	1000	1180	35,00							

## HMO Dubbelwerkende Cilinder

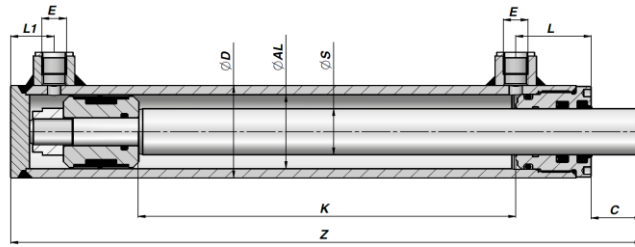

Artikelnummer	Ø D	Ø AL	Ø S	K Slag	Z	Kg	E BSP	L	L1	C
26.090400100	105	90	40	100	286		1/2"	60	40	23
26.090400200				200	386					
26.090400300				300	486					
26.090400400				400	586					
26.090400500				500	686					
26.090400600				600	786					
26.090400700				700	886					
26.090400800				800	986					
26.090400900				900	1086					
26.090401000				1000	1186					
26.090500200	105	90	50	200	386		1/2"	60	40	23
26.090500300				300	486	19,30				
26.090500400				400	586	22,64				
26.090500500				500	686	25,97				
26.090500600				600	786	29,30				
26.090500700				700	886	32,63				
26.090500800				800	986	35,97				
26.090500900				900	1086					
26.090501000				1000	1186	42,64				
26.100500200				115	100	50				
26.100500250	250	460	21,38							
26.100500300	300	510	23,14							
26.100500400	400	610	26,65							
26.100500500	500	710	30,17							
26.100500600	600	810	33,69							
26.100500700	700	910	37,21							
26.100500800	800	1010	40,72							
26.100501000	1000	1210	47,50							
26.100600300	115	100	60				300	510	25,32	1/2"
26.100600400				400	610	29,52				
26.100600500				500	710	33,71				
26.100600600				600	810	37,90				
26.100600700				700	910	42,10				
26.100600800				800	1010	46,30				
26.100601000				1000	1210	54,69				