

4XP

Norm: EN 856

HOGEDRUKSLANG VZV 4 STAALINLAGEN

KG-2010

Temp.bereik: -40°C / +100°C (Max.+120°C)

Persmantel: **PM 4(-NS)**.

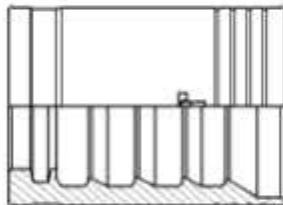

Branding:



4XP08 DN12 12.5mm(1/2) WP42.5MPa(6150PSI) ISO3862/EN856 4SP MSHA

Slang Ø inw.(mm)	Slang Ø uitw.(mm)	Werdruk (Bar)	Barstdruk (Bar)	Buig- radius	Gew. (gr/mtr)	Bestel nr.	Prijs
6,4 (1/4")	17,6	450	1800	150	585	4SPNW6	19,16
9,5 (3/8")	21,2	460	2050	110*	715	4XPNW10	19,52
12,7 (1/2")	24,3	425	1700	120*	940	4XPNW13	21,04
16,0 (5/8")	27,7	400	1600	140*	970	4XPNW16	23,98
19,0 (3/4")	32,0	350	1400	300	1500	4SPNW20	26,87

*=Extreem flexibel !!