

Product Specificaties	
Max werkdruk cilinder (Bar)	180
Max snelheid cilinder (m/s)	0,5
Temperatuur afdichtingen (°C)	-25 / +80

HMOLM

## Dubbelwerkende Cilinder

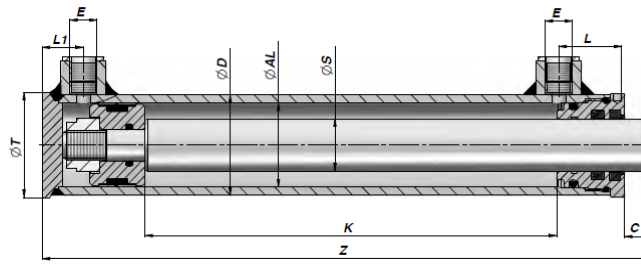
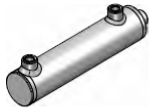

Artikelnummer	Ø D	Ø AL	Ø S	K Slag	Z	Kg	E BSP	L	L1	C	Ø T
HMOLM0400200100	48	40	20	100	195	1,75	1/4"	32	20	12	50
HMOLM0400200150				150	245	2,09					
HMOLM0400200200				200	295	2,43					
HMOLM0400200250				250	345	2,76					
HMOLM0400200300				300	395	3,09					
HMOLM0400200400				400	495	3,78					
HMOLM0400200500				500	595	4,46					
HMOLM0400250100	48	40	25	100	195	1,90	1/4"	32	20	12	50
HMOLM0400250150				150	245	2,31					
HMOLM0400250200				200	295	2,72					
HMOLM0400250250				250	345	3,14					
HMOLM0400250300				300	395	3,53					
HMOLM0400250400				400	495	4,35					
HMOLM0400250500				500	595	5,17					
HMOLM0500250100	58	50	25	100	205	2,60	3/8"	36	22	13	60
HMOLM0500250150				150	255	3,06					
HMOLM0500250200				200	305	3,52					
HMOLM0500250250				250	355	3,97					
HMOLM0500250300				300	405	4,43					
HMOLM0500250400				400	505	5,34					
HMOLM0500250500				500	605	6,27					
HMOLM0500300100	58	50	25	100	205	2,78	3/8"	36	22	13	60
HMOLM0500300150				150	255	3,32					
HMOLM0500300200				200	305	3,87					
HMOLM0500300250				250	355	4,41					
HMOLM0500300300				300	405	4,95					
HMOLM0500300400				400	505	6,03					
HMOLM0500300500				500	605	7,12					
HMOLM0600300100	68	60	30	100	220	3,77	3/8"	39	25	13	70
HMOLM0600300150				150	270	4,36					
HMOLM0600300200				200	320	4,95					
HMOLM0600300250				250	370	5,54					
HMOLM0600300300				300	420	6,13					
HMOLM0600300400				400	520	7,32					
HMOLM0600300500				500	620	8,50					
HMOLM0600350100	68	60	35	100	220	3,99	3/8"	39	25	13	70
HMOLM0600350150				150	270	4,68					
HMOLM0600350200				200	320	5,37					
HMOLM0600350250				250	370	6,06					
HMOLM0600350300				300	420	6,75					
HMOLM0600350400				400	520	8,14					
HMOLM0600350500				500	620	9,52					
HMOLM0700350100	78	70	35	100	220	4,82	3/8"	39	25	13	80
HMOLM0700350150				150	270	5,56					
HMOLM0700350200				200	320	6,30					
HMOLM0700350250				250	370	7,04					
HMOLM0700350300				300	420	7,80					
HMOLM0700350400				400	520	9,27					
HMOLM0700350500				500	620	10,76					
HMOLM0700400200	78	70	35	200	320	6,79	3/8"	39	25	13	80
HMOLM0700400250				250	370	7,64					
HMOLM0700400300				300	420	8,50					
HMOLM0700400400				400	520	10,21					
HMOLM0700400500				500	620	11,94					