

Straight Male Stud Standpipe Fitting
Type FI-EGE-...-N • Series L / S

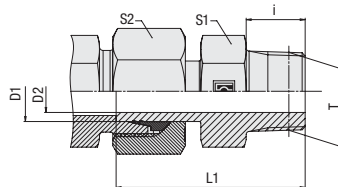

NPT Thread

Ordering Codes

***FI-EGE*-10*L*1/4*N*-W3*-SV**

- * Straight Male Stud Standpipe Fitting **FI-EGE**
- * Outside Tube Diameter D1 (in mm) **-10**
- * Series **L** (Light Series) or **S** (Heavy Series)
- * Thread Size **1/4** (acc. to dimension table)
 Please always indicate thread sizes, e.g. 1/4!
- * Thread Type **N** (NPT Thread)
- * Material Code **-W3** (Steel, zinc/nickel-plated)
 Please contact STAUFF for alternative materials and surface finishings.
- * Assembling / Kitting **-SV** (Fitting body assembled with cutting ring and union nut on the standpipe)

Series	Tube OD (mm/in) D1	PN (bar/psi)	Dimensions (mm/in)						Weight (kg/lbs) ca. per 100 ¹	Ordering Codes ²
			Thread T	D2	L1	i	S1	S2		
L	6	315	1/8 NPT	3,3	33	10	11	14	2,27	FI-EGE-06L1/8N-W3-SV
	.24	4567,5		.13	1.30	.39	.43	.55	4.99	
	8	315	1/4 NPT	4	40	15,5	14	17	3,93	FI-EGE-08L1/4N-W3-SV
	.31	4567,5		.16	1.57	.61	.55	.67	8.64	
	10	315	1/4 NPT	6,5	41	15,5	14	19	4,46	FI-EGE-10L1/4N-W3-SV
	.39	4567,5		.26	1.61	.61	.55	.75	9.81	
	12	315	3/8 NPT	7	42	15,5	19	22	6,80	FI-EGE-12L3/8N-W3-SV
	.47	4567,5		.28	1.65	.61	.75	.87	14.97	
	15	315	1/2 NPT	10	46,5	20	22	27	10,48	FI-EGE-15L1/2N-W3-SV
	.59	4567,5		.39	1.83	.79	.87	1.06	23.05	
	18	315	1/2 NPT	13	49,5	20	22	32	13,44	FI-EGE-18L1/2N-W3-SV
	.71	4567,5		.51	1.95	.79	.87	1.26	29.56	
	22	160	3/4 NPT	16,5	49	20	27	36	18,41	FI-EGE-22L3/4N-W3-SV
	.87	2320		.65	1.93	.79	1.06	1.42	40.51	
	28	160	1 NPT	22	55,5	25	36	41	25,80	FI-EGE-28L1N-W3-SV
	1.10	2320		.87	2.19	.98	1.42	1.61	56.76	
	35	160	1 1/4 NPT	28	74,1	25,6	46	50	42,40	FI-EGE-35L1-1/4N-W3-SV
	1.38	2320		1.10	2.92	1.01	1.81	1.97	93.28	
42	160	1 1/2 NPT	34	78,5	26	50	60	62,33	FI-EGE-42L1-1/2N-W3-SV	
1.65	2320		1.34	3.09	1.02	1.97	2.36	137.13		
S	6	630	1/4 NPT	3	45,1	15,1	14	17	1,92	FI-EGE-06S1/4N-W3-SV
	.24	9135		.12	1.78	.59	.55	.67	4.23	
	8	630	1/4 NPT	4,3	40	15,5	14	19	4,45	FI-EGE-08S1/4N-W3-SV
	.31	9135		.17	1.57	.61	.55	.75	9.78	
	10	630	3/8 NPT	6	44,5	15,5	19	22	7,29	FI-EGE-10S3/8N-W3-SV
	.39	9135		.24	1.75	.61	.75	.87	16.04	
	12	630	3/8 NPT	7,3	46,5	15,5	19	24	8,49	FI-EGE-12S3/8N-W3-SV
	.47	9135		.29	1.83	.61	.75	.94	18.67	
	14	630	1/2 NPT	10,5	53,5	20	22	27	12,81	FI-EGE-14S1/2N-W3-SV
	.55	9135		.41	2.11	.79	.87	1.06	28.19	
	16	630	1/2 NPT	13,5	58	20	22	30	16,52	FI-EGE-16S1/2N-W3-SV
	.63	9135		.53	2.28	.79	.87	1.18	36.34	
	20	400	3/4 NPT	17,5	68	25	27	36	24,50	FI-EGE-20S3/4N-W3-SV
	.79	5800		.69	2.68	.98	1.06	1.42	53.90	
	25	400	1 NPT	17,5	68	25	36	46	41,13	FI-EGE-25S1N-W3-SV
	.98	5800		.69	2.68	.98	1.42	1.81	90.49	
	30	400	1 1/4 NPT	22	70,5	26	46	50	52,80	FI-EGE-30S1-1/4N-W3-SV
	1.18	5800		.87	2.78	1.02	1.81	1.97	116.16	
38	400	1 1/2 NPT	29	92	26	50	60	83,60	FI-EGE-38S1-1/2N-W3-SV	
1.50	5800		1.14	3.62	1.02	1.97	2.36	183.92		

¹ Weight including cutting ring and union nut on the standpipe.

² Standard scope of delivery: Fitting body assembled with cutting ring and union nut on the standpipe.

Male stud acc. to ANSI/ASME B1.20.1-1983
 Port acc. to ANSI/ASME B1.20.1-1983

Suitable liquid / plastic sealant required.

Please note: Standpipes are always factory-assembled with cutting rings and union nuts.

The union nut assembled on the standpipe has to be tightened by only 1/12 a turn (equivalent to 30°) beyond the fixed point.



Male threaded studs were designed for female threaded ports in components made of steel. For applications with components made of softer mating materials (e.g. Aluminium), the use of connectors with additionally rolled male threads is recommended.

Please contact STAUFF prior to the assembly for further information.