

## Adjustable Male Stud Elbow (90°) with Lock Nut Type FI-WEE-...-M-OR • Series L / S

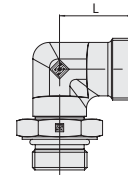
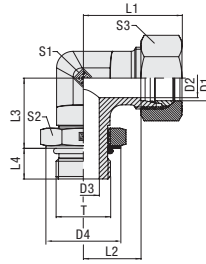

Metric Parallel Thread

O-Ring

Series	Tube OD (mm/in)	PN (bar/PSI)	Dimensions (mm/in)	Dimensions											Torque (Nm/ft-lb)	Weight (kg/lbs) ca.	Ordering Codes <sup>3</sup>
				Thread T	D2	D3	D4	L	L1 <sup>1</sup>	L2	L3	L4	S1	S2			
L	6	315	M 10 x 1	4	4	14,5	21	29	14	20	7	14	14	14	15	5,16	FI-WEE-06LM-OR-B-W3-MS
	.24	4568		.16	.16	.57	.83	1.14	.55	.79	.28	.55	.55	.55	11.1	11.35	
	8	315	M 12 x 1,5	6	4	17,5	23	31	16	23,5	10	14	17	25	5,44	FI-WEE-08LM-OR-B-W3-MS	
	.31	4568		.24	.16	.69	.91	1.22	.63	.93	.39	.55	.67	.67	18.5		11.96
	10	315	M 14 x 1,5	8	5	19,5	24	32	17	27	10	19	19	19	35	9,00	FI-WEE-10LM-OR-B-W3-MS
	.39	4568		.31	.20	.77	.94	1.26	.67	1.06	.39	.75	.75	.75	25.9	19.80	
	12	315	M 16 x 1,5	10	7	22,5	26	34	19	27	10	19	22	22	40	10,23	FI-WEE-12LM-OR-B-W3-MS
	.47	4568		.39	.28	.89	1.02	1.34	.75	1.06	.39	.75	.87	.87	29.6	22.51	
	15	315	M 18 x 1,5	12	8	24,5	28	36	21	29	11	22	24	27	45	14,59	FI-WEE-15LM-OR-B-W3-MS
	.59	4568		.47	.31	.96	1.10	1.42	.83	1.14	.43	.87	.94	1.06	33.3	32.11	
	18	250	M 22 x 1,5	15	12	27,5	31	40	23,5	36	12	27	27	32	60	23,09	FI-WEE-18LM-OR-B-W3-MS
	.71	3625		.59	.47	1.08	1.22	1.57	.93	1.42	.47	1.06	1.06	1.26	44.4	50.80	
	22	160	M 27 x 2	19	16	32,5	35	44	27,5	38	14	30	32	36	100	39,11	FI-WEE-22LM-OR-B-W3-MS
	.87	2320		.75	.63	1.28	1.38	1.73	1.08	1.50	.55	1.18	1.26	1.42	74.0	86.04	
	28	160	M 33 x 2	24	20	41,5	38	47	30,5	47	14	36	41	41	160	61,54	FI-WEE-28LM-OR-B-W3-MS
	1.10	2320		.94	.79	1.63	1.50	1.85	1.20	1.85	.55	1.42	1.61	1.61	118.4	135.38	
35	160	M 42 x 2	30	25	50,5	48	59	37,5	58	14	50	50	50	210	131,90	FI-WEE-35LM-OR-B-W3-MS	
1.38	2320		1.18	.98	1.99	1.89	2.32	1.48	2.28	.55	1.97	1.97	1.97	155.4	290.18		
42	160	M 48 x 2	36	32	55,5	49	61	38	58,5	16	50	55	60	260	136,43	FI-WEE-42LM-OR-B-W3-MS	
1.65	2320		1.42	1.26	2.19	1.93	2.40	1.50	2.30	.63	1.97	2.17	2.36	192.4	300.15		
S	6	315	M 12 x 1,5	4	4	17,5	22	30	15	23,5	10	14	17	35	7,62	FI-WEE-06SM-OR-B-W3-MS	
	.24	4568		.16	.16	.69	.87	1.18	.59	.93	.39	.55	.67	.67	25.9		16.77
	8	315	M 14 x 1,5	5	5	19,5	24	32	17	27	10	19	19	45	11,98	FI-WEE-08SM-OR-B-W3-MS	
	.31	4568		.20	.20	.77	.94	1.26	.67	1.06	.39	.75	.75	.75	33.3		26.35
	10	315	M 16 x 1,5	7	7	22,5	25	34	17,5	26	11	19	22	55	10,81	FI-WEE-10SM-OR-B-W3-MS	
	.39	4568		.28	.28	.89	.98	1.34	.69	1.02	.43	.75	.87	.87	40.7		23.79
	12	315	M 18 x 1,5	8	8	24,5	29	38	21,5	28	12	22	24	70	15,60	FI-WEE-12SM-OR-B-W3-MS	
	.47	4568		.31	.31	.96	1.14	1.50	.85	1.10	.47	.87	.94	.94	51.8		34.32
	16	250	M 22 x 1,5	12	12	27,5	33	43	24,5	34	14	27	27	30	100	24,52	FI-WEE-16SM-OR-B-W3-MS
	.63	3625		.47	.47	1.08	1.30	1.69	.96	1.34	.55	1.06	1.06	1.18	74.0	53.94	
	20	250	M 27 x 2	16	16	32,5	38	49	27,5	36	16	30	32	36	170	33,16	FI-WEE-20SM-OR-B-W3-MS
	.79	3625		.63	.63	1.28	1.50	1.93	1.08	1.42	.63	1.18	1.26	1.42	125.8	72.96	
	25	160	M 33 x 2	20	20	41,5	42	54	30	45	16	36	41	46	310	56,70	FI-WEE-25SM-OR-B-W3-MS
	.98	2320		.79	.79	1.63	1.65	2.13	1.18	1.77	.63	1.42	1.61	1.81	229.4	124.74	
30	160	M 42 x 2	25	25	50,5	49	62	35,5	55	17	50	50	330	144,57	FI-WEE-30SM-OR-B-W3-MS		
1.18	2320		.98	.98	1.99	1.93	2.44	1.40	2.17	.67	1.97	1.97	1.97	244.2		318.05	
38	160	M 48 x 2	32	32	55,5	50	65	34	55,5	19	50	55	60	420	152,80	FI-WEE-38SM-OR-B-W3-MS	
1.50	2320		1.26	1.26	2.19	1.97	2.56	1.34	2.19	.75	1.97	2.17	2.36	310.8	336.17		

<sup>1</sup> Approximate dimension in assembled condition.

<sup>2</sup> Weight excluding cutting ring and union nut.

<sup>3</sup> Standard scope of delivery: Fitting body only.

Standard seal material is NBR (Buna-N®).

Male stud according to ISO 6149-2/-3  
Port according to ISO 6149-1

Torque recommendations for Steel mating material.

Male threaded studs were designed for female threaded ports in components made of steel. For applications with components made of softer mating materials (e.g. Aluminium), the use of connectors with additionally rolled male threads is recommended.

Please contact STAUFF prior to the assembly for further information.

### Ordering Codes

#### \*FI-WEE\*-10\*L\*M\*-OR\*-B\*-W3\*-MS

- \* Adjustable Male Stud Elbow (90°) with Lock Nut **FI-WEE**
- \* Outside Tube Diameter (in mm) **-10**
- \* Series Light Series **L**  
Heavy Series **S**
- \* Thread Type Metric Parallel Thread **M**

If required, please indicate special sizes, e.g. M26x1.5!

- \* Seal Type O-Ring **-OR**
- \* Seal Material NBR (Buna-N®) **-B**  
FKM (Viton®) **-V**  
EPDM **-E**
- \* Material Code Steel, zinc/nickel-plated **-W3**

Please contact STAUFF for alternative materials and surface finishings.

- \* Assembling / Kitting Fitting body only **—**
- Fitting body supplied with cutting ring and union nut **-MS**
- Fitting body supplied with soft-sealing cutting ring and union nut **-MSV**