

**Adjustable Male Stud Elbow (45°) with Lock Nut
Type FI-VEE-...-M-OR • Series L / S**
Type FI-VEE-...-M-OR
**Metric Parallel Thread
O-Ring**

 Male stud according to ISO 6149-2/-3
 Port according to ISO 6149-1

Dimensions L, L1, L2 and L3 deviating from the dimension table on the left.

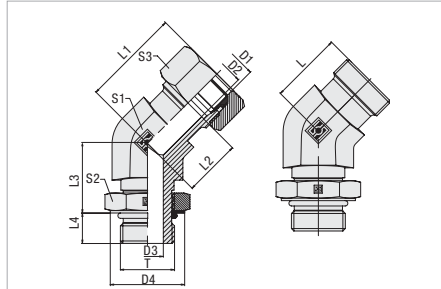

Male threaded studs were designed for female threaded ports in components made of steel. For applications with components made of softer mating materials (e.g. Aluminium), the use of connectors with additionally rolled male threads is recommended.

Please contact STAUFF prior to the assembly for further information.

Connecting Parts

 Cutting Ring
 Type **FI-DS**

 Soft-Sealing Cutting Ring
 Type **FI-WDDS**

 Support Sleeve
 Type **FI-VH**

 STAUFF Form Ring
 Type **FI-AR**

 Union Nut
 Type **FI-M**

 37° Flared Tube Fitting Set
 Type **FI-AB**
Spare Parts / Accessories

 O-Ring
 Type **O-RING**