

Straight Male Stud Standpipe Fitting
Type FI-EGE-...-R • Series L / S

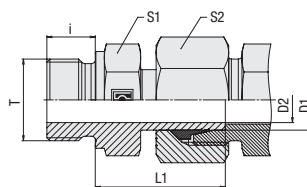

Whitworth Parallel Pipe Thread (BSPP)

Metallic Sealing Edge

Ordering Codes

***FI-EGE*-10*L*R*-W3*-SV**

- * Straight Male Stud Standpipe Fitting **FI-EGE**
- * Outside Tube Diameter D1 (in mm) **-10**
- * Series **L**
 Light Series
 Heavy Series **S**
- * Thread Type **R**
 Whitworth Parallel
 Pipe Thread (BSPP)
- If required, please indicate special sizes, e.g. R1/R!
- * Material Code **-W3**
 Steel, zinc/nickel-plated
- Please contact STAUFF for alternative materials and surface finishings.
- * Assembling / Kitting **-SV**
 Fitting body assembled with cutting ring and union nut on the standpipe

Series	Tube OD		PN (PB)	Dimensions						Torque (^{N-m} /ft-lb)	Weight (^{kg} /lbs) ca. per 100 ¹	Ordering Codes ²
	(mm/in)	(mm/in)		Thread	T	D2	L1	i	S1			
L	6	315	G 1/8	3,5	24,5	8	14	14	18	2,50	FI-EGE-06LR-W3-SV	
	.24	4568		.14	.96	.31	.55	.55	13.3	5.50		
	8	315	G 1/4	4,5	29,5	12	19	17	35	5,53	FI-EGE-08LR-W3-SV	
	.31	4568		.18	1.16	.47	.75	.67	25.9	12.17		
	10	315	G 1/4	7	27,5	12	19	19	35	5,11	FI-EGE-10LR-W3-SV	
	.39	4568		.28	1.08	.47	.75	.75	25.9	11.23		
	12	315	G 3/8	7,5	34	12	22	22	70	8,25	FI-EGE-12LR-W3-SV	
	.47	4568		.30	1.34	.47	.87	.87	51.8	18.15		
	15	315	G 1/2	11	32	14	27	27	110	13,02	FI-EGE-15LR-W3-SV	
	.59	4568		.43	1.26	.55	1.06	1.06	81.4	28.65		
	18	315	G 1/2	14	31,5	14	27	32	110	13,86	FI-EGE-18LR-W3-SV	
	.71	4568		.55	1.24	.55	1.06	1.26	81.4	30.48		
	22	160	G 3/4	18	32,5	16	32	36	180	19,98	FI-EGE-22LR-W3-SV	
	.87	2320		.71	1.28	.63	1.26	1.42	133.2	43.96		
	28	160	G 1	23	35	18	41	41	330	27,39	FI-EGE-28LR-W3-SV	
	1.10	2320		.91	1.38	.71	1.61	1.61	244.2	60.26		
	35	160	G 1 1/4	29,5	42,5	20	50	50	540	47,03	FI-EGE-35LR-W3-SV	
	1.38	2320		1.16	1.67	.79	1.97	1.97	399.6	103.47		
42	160	G 1 1/2	35,5	46,5	22	55	60	630	72,00	FI-EGE-42LR-W3-SV		
1.65	2320		1.40	1.83	.87	2.17	2.36	466.2	158.40			
S	6	PB630	G 1/4	3,5	27	12	19	17	55	4,98	FI-EGE-06SR-W3-SV	
	.24	PB9135		.14	1.06	.47	.75	.67	40.7	10.96		
	8	PB630	G 1/4	4,5	29,5	12	19	19	55	5,98	FI-EGE-08SR-W3-SV	
	.31	PB9135		.18	1.16	.47	.75	.75	40.7	13.16		
	10	PB630	G 3/8	6,5	32	12	22	22	90	8,81	FI-EGE-10SR-W3-SV	
	.39	PB9135		.26	1.26	.47	.87	.87	66.6	19.39		
	12	PB630	G 3/8	7,5	34	12	22	24	90	10,01	FI-EGE-12SR-W3-SV	
	.47	PB9135		.30	1.34	.47	.87	.94	66.6	22.01		
	14	PB630	G 1/2	9,5	36,5	14	27	27	130	13,95	FI-EGE-14SR-W3-SV	
	.55	PB9135		.37	1.44	.55	1.06	1.06	96.2	30.69		
	16	PB400	G 1/2	11,5	37	14	27	30	130	16,94	FI-EGE-16SR-W3-SV	
	.63	PB5800		.45	1.46	.55	1.06	1.18	96.2	37.28		
	20	PB400	G 3/4	15,5	43	16	32	36	270	26,98	FI-EGE-20SR-W3-SV	
	.79	PB5800		.61	1.69	.63	1.26	1.42	199.8	59.36		
	25	PB400	G 1	18	48	18	41	46	340	49,03	FI-EGE-25SR-W3-SV	
	.98	PB5800		.71	1.89	.71	1.61	1.81	251.6	107.87		
	30	PB400	G 1 1/4	23,5	51	20	50	50	540	69,13	FI-EGE-30SR-W3-SV	
	1.18	PB5800		.93	2.01	.79	1.97	1.97	399.6	152.08		
38	PB315	G 1 1/2	29	60	22	55	60	700	98,20	FI-EGE-38SR-W3-SV		
1.50	PB4568		1.14	2.36	.87	2.17	2.36	518.0	216.04			

¹Weight including cutting ring and union nut on the standpipe.

²Standard scope of delivery: Fitting body assembled with cutting ring and union nut on the standpipe.

Please note: Standpipes are always factory-assembled with cutting rings and union nuts.

The union nut assembled on the standpipe has to be tightened by only 1/12 a turn (equivalent to 30°) beyond the fixed point.



Male stud acc. to DIN 3852-2 (Form B) / ISO 1179-4 (Type B)
 Port acc. to DIN 3852-2 (Form X) / ISO 1179-1

Torque recommendations for Steel mating material.

Male threaded studs were designed for female threaded ports in components made of steel. For applications with components made of softer mating materials (e.g. Aluminium), the use of connectors with additionally rolled male threads is recommended. Please contact STAUFF prior to the assembly for further information.