

Check Valve
Type FI-RV • Series L / S

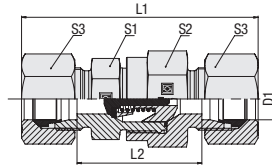

Standard Opening Pressure: 1 bar / 14.5 PSI

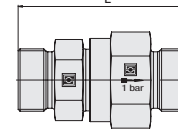

Ordering Codes

***FI-RV*-10*L*-W3*-1*-MS**

- * Check Valve **FI-RV**
- * Outside Tube Diameter D1 (in mm) **-10**
- * Series **L**
Light Series **S**
Heavy Series
- * Material Code **-W3**
Steel, zinc/nickel-plated
- Please contact STAUFF for alternative materials and surface finishings.
- * Opening Pressure **1**
1 bar / 14.5 PSI
Contact STAUFF for alternative opening pressures.
- * Assembling / Kitting **—**
Valve body only
- MS**
Valve body supplied with cutting rings and union nuts
- MSV**
Valve body supplied with soft-sealing cutting rings and union nuts

Connecting Parts

- Cutting Ring
Type **FI-DS**
- Soft-Sealing Cutting Ring
Type **FI-WDDS**
- Support Sleeve
Type **FI-VH**
- STAUFF Form Ring
Type **FI-AR**
- Union Nut
Type **FI-M**
- 37° Flared Tube Fitting Set
Type **FI-AB**

Series	Tube OD (mm/in)	PN (bar/PSI)	Dimensions					Weight (kg/lbs) ca. per 100 ²	Ordering Codes ³	
			D1	L	L1 ¹	L2	S1			S2
L	6	400	52	67	38	22	27	14	11,93	FI-RV-06L-W3-1
	.24	5800	2,05	2,64	1,50	.87	1,06	.55	26,24	
	8	400	52	67	38	22	27	17	12,41	FI-RV-08L-W3-1
	.31	5800	2,05	2,64	1,50	.87	1,06	.67	27,30	
	10	400	52	67	38	22	27	19	11,65	FI-RV-10L-W3-1
	.39	5800	2,05	2,64	1,50	.87	1,06	.75	25,64	
	12	400	53	68	39	22	27	22	12,31	FI-RV-12L-W3-1
	.47	5800	2,09	2,68	1,54	.87	1,06	.87	27,07	
	15	400	58	74	44	27	32	27	18,29	FI-RV-15L-W3-1
	.59	5800	2,28	2,91	1,73	1,06	1,26	1,06	40,25	
	18	400	63	80	48	27	32	32	22,54	FI-RV-18L-W3-1
	.71	5800	2,48	3,15	1,89	1,06	1,26	1,26	49,59	
	22	250	75	92	60	41	46	36	48,21	FI-RV-22L-W3-1
	.87	3625	2,95	3,62	2,36	1,61	1,81	1,42	106,05	
	28	250	81	99	66	41	46	41	57,90	FI-RV-28L-W3-1
	1.10	3625	3,19	3,90	2,60	1,61	1,81	1,61	127,38	
	35	250	92	114	71	60	70	50	129,80	FI-RV-35L-W3-1
	1.38	3625	3,62	4,49	2,80	2,36	2,76	1,97	285,56	
	42	250	87	111	65	60	70	60	122,60	FI-RV-42L-W3-1
	1.65	3625	3,43	4,37	2,56	2,36	2,76	2,36	269,72	
S	6	400	56	71	42	22	27	17	13,12	FI-RV-06S-W3-1
	.24	5800	2,20	2,80	1,65	.87	1,06	.67	28,87	
	8	400	52	67	38	22	27	19	11,98	FI-RV-08S-W3-1
	.31	5800	2,05	2,64	1,50	.87	1,06	.75	26,35	
	10	400	54	71	39	22	27	22	13,20	FI-RV-10S-W3-1
	.39	5800	2,13	2,80	1,54	.87	1,06	.87	29,04	
	12	400	55	72	40	22	27	24	13,61	FI-RV-12S-W3-1
	.47	5800	2,17	2,83	1,57	.87	1,06	.94	29,94	
	14	400	62	81	46	27	32	27	19,98	FI-RV-14S-W3-1
	.55	5800	2,44	3,19	1,81	1,06	1,26	1,06	43,96	
	16	400	65	84	48	27	32	30	21,56	FI-RV-16S-W3-1
	.63	5800	2,56	3,31	1,89	1,06	1,26	1,18	47,44	
	20	400	78	100	57	41	46	36	50,20	FI-RV-20S-W3-1
	.79	5800	3,07	3,94	2,24	1,61	1,81	1,42	110,45	
	25	250	81	105	57	41	46	46	52,60	FI-RV-25S-W3-1
	.98	3625	3,19	4,13	2,24	1,61	1,81	1,81	115,72	
	30	250	91	117	64	50	55	50	80,70	FI-RV-30S-W3-1
	1.18	3625	3,58	4,61	2,52	1,97	2,17	1,97	177,54	
38	250	99	129	67	60	70	60	136,00	FI-RV-38S-W3-1	
1.50	3625	3,90	5,08	2,64	2,36	2,76	2,36	299,20		

¹ Approximate dimension in assembled condition.

² Weight excluding cutting rings and union nuts.

³ Standard scope of delivery: Valve body only.

Please note: Internal seals are made of FKM (Viton®).

In order to make sure that the valves will be suitable for your particular application, please contact STAUFF with details on media, operating pressure, pressure peaks, operating temperature and the expected frequency of valve actuations.