

Tee Reducer
Type FI-T • Series L / S

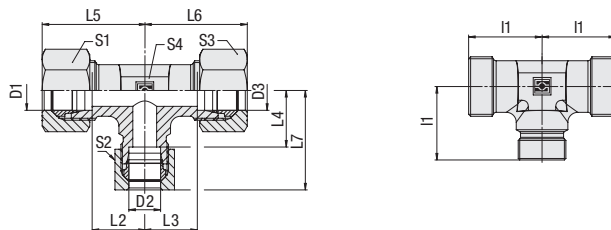

Sequence of connections
in the ordering codes for
tee reducers:



Ordering Codes

***FI-T*-10/*08/*10*L*-W3*-MS**

- * Tee Reducer FI-T
- * Outside Tube Diameter D1 (in mm) -10
- * Outside Tube Diameter D2 (in mm) 08
- * Outside Tube Diameter D3 (in mm) 10
- * Series L
Light Series (page 87)
S
Heavy Series (page 88)
- * Material Code -W3
Steel, zinc/nickel-plated
- Please contact STAUFF for alternative materials and surface finishings.
- * Assembling / Kitting —
Fitting body only
- MS
Fitting body supplied with cutting rings and union nuts
- MSV
Fitting body supplied with soft-sealing cutting rings and union nuts

Connecting Parts

- Cutting Ring
Type **FI-DS**
- Soft-Sealing Cutting Ring
Type **FI-WDDS**
- Support Sleeve
Type **FI-VH**
- STAUFF Form Ring
Type **FI-AR**
- Union Nut
Type **FI-M**
- 37° Flared Tube Fitting Set
Type **FI-AB**

Series	Tube OD (mm/in)			PN (bar/psi)	Dimensions (mm/in)													Weight (kg/lbs) ca. per 100 ²	Ordering Codes ³
	D1	D2	D3		I1	L1	L2	L3	L4	L5 ¹	L6 ¹	L7 ¹	S1	S2	S3				
L	22	10	22	250	35	27,5	28	27,5	44	43	44	36	19	36	27	19,89	FI-T-22/10/22L-W3		
	.87	.39	.87	3625	1.38	1.08	1.10	1.08	1.73	1.69	1.73	1.42	.75	1.42	1.06	43,75			
	22	12	22	250	35	27,5	28	27,5	44	43	44	36	22	36	27	20,30	FI-T-22/12/22L-W3		
	.87	.47	.87	3625	1.38	1.08	1.10	1.08	1.73	1.69	1.73	1.42	.87	1.42	1.06	44,66			
	22	15	22	250	35	27,5	28	27,5	44	43	44	36	27	36	27	20,19	FI-T-22/15/22L-W3		
	0,87	.59	.87	3625	1.38	1.08	1.10	1.08	1.73	1.69	1.73	1.42	1.06	1.42	1.06	44,43			
	22	18	22	250	35	27,5	27,5	27,5	44	44	44	36	32	36	27	20,29	FI-T-22/18/22L-W3		
	.87	.71	.87	3625	1.38	1.08	1.08	1.08	1.73	1.73	1.73	1.42	1.26	1.42	1.06	44,64			
	28	10	28	250	38	30,5	31	30,5	47	46	47	41	19	41	36	32,82	FI-T-28/10/28L-W3		
	1.10	.39	1.10	3625	1.50	1.20	1.22	1.20	1.85	1.81	1.85	1.61	.75	1.61	1.42	72,20			
	28	12	28	250	38	30,5	31	30,5	47	46	47	41	22	41	36	34,10	FI-T-28/12/28L-W3		
	1.10	.47	1.10	3625	1.50	1.20	1.22	1.20	1.85	1.81	1.85	1.61	.87	1.61	1.42	75,02			
	28	15	28	250	38	30,5	31	30,5	47	46	47	41	27	41	36	22,97	FI-T-28/15/28L-W3		
	1.10	.59	1.10	3625	1.50	1.20	1.22	1.20	1.85	1.81	1.85	1.61	1.06	1.61	1.42	50,54			
	28	18	28	250	38	30,5	30,5	30,5	47	47	47	41	32	41	36	18,70	FI-T-28/18/28L-W3		
	1.10	.71	1.10	3625	1.50	1.20	1.20	1.20	1.85	1.85	1.85	1.61	1.42	1.61	1.42	41,14			
	28	22	28	250	38	30,5	30,5	30,5	47	47	47	41	36	41	36	31,70	FI-T-28/22/28L-W3		
	1.10	.87	1.10	3625	1.50	1.20	1.20	1.20	1.85	1.85	1.85	1.61	1.42	1.61	1.42	69,74			
	35	18	35	250	45	34,5	37,5	34,5	56	54	56	50	32	50	41	59,68	FI-T-35/18/35L-W3		
	1.38	.71	1.38	3625	1.77	1.36	1.48	1.36	2.20	2.13	2.20	1.97	1.26	1.97	1.61	131,30			
	35	22	35	250	45	34,5	37,5	34,5	56	54	56	50	36	50	41	55,00	FI-T-35/22/35L-W3		
	1.38	.87	1.38	3625	1.77	1.36	1.48	1.36	2.20	2.13	2.20	1.97	1.42	1.97	1.61	121,00			
	35	28	35	250	45	34,5	37,5	34,5	56	54	56	50	41	50	41	49,74	FI-T-35/28/35L-W3		
	1.38	1.10	1.38	3625	1.77	1.36	1.48	1.36	2.20	2.13	2.20	1.97	1.61	1.97	1.61	109,43			
	42	22	42	250	51	40	43,5	40	63	60	63	60	36	60	50	102,57	FI-T-42/22/42L-W3		
	1.65	.87	1.65	3625	2.01	1.57	1.71	1.57	2.48	2.36	2.48	2.36	1.42	2.36	1.97	225,66			
42	28	42	250	51	40	43,5	40	63	60	63	60	41	60	50	77,33	FI-T-42/28/42L-W3			
1.65	1.10	1.65	3625	2.01	1.57	1.71	1.57	2.48	2.36	2.48	2.36	1.61	2.36	1.97	170,13				
42	35	42	250	51	40	40,5	40	63	62	63	60	50	60	50	80,30	FI-T-42/35/42L-W3			
1.65	1.38	1.65	3625	2.01	1.57	1.59	1.57	2.48	2.44	2.48	2.36	1.97	2.36	1.97	176,66				
S	16	8	16	630	33	24,5	26	24,5	43	41	43	30	19	30	24	18,08	FI-T-16/08/16S-W3		
	.63	.31	.63	9135	1.30	.96	1.02	.96	1.69	1.61	1.69	1.18	.75	1.18	.94	39,78			
	16	10	16	630	33	24,5	25,5	24,5	43	42	43	30	22	30	24	18,12	FI-T-16/10/16S-W3		
	.63	.39	.63	9135	1.30	.96	1.00	.96	1.69	1.65	1.69	1.18	.87	1.18	.94	39,86			
	16	12	16	630	33	24,5	25,5	24,5	43	42	43	30	24	30	24	18,10	FI-T-16/12/16S-W3		
	.63	.47	.63	9135	1.30	.96	1.00	.96	1.69	1.65	1.69	1.18	.94	1.18	.94	39,82			
	20	10	20	400	37	26,5	29,5	26,5	48	46	48	36	22	36	27	28,30	FI-T-20/10/20S-W3		
	.79	.39	.79	5800	1.46	1.04	1.16	1.04	1.89	1.81	1.89	1.42	.87	1.42	1.06	62,26			
	20	16	20	400	37	26,5	28,5	26,5	48	47	48	36	30	36	27	26,21	FI-T-20/16/20S-W3		
	.79	.63	.79	5800	1.46	1.04	1.12	1.04	1.89	1.85	1.89	1.42	1.18	1.42	1.06	57,66			
	25	16	25	400	42	30	33,5	30	54	52	54	46	30	46	36	45,80	FI-T-25/16/25S-W3		
	.98	.63	.98	5800	1.65	1.18	1.32	1.18	2.13	2.05	2.13	1.81	1.18	1.81	1.42	100,76			
	25	20	25	400	42	30	31,5	30	54	53	54	46	36	46	36	45,04	FI-T-25/20/25S-W3		
	.98	.79	.98	5800	1.65	1.18	1.24	1.18	2.13	2.09	2.13	1.81	1.42	1.81	1.42	99,08			
	25	30	25	400	49	37	35,5	37	61	62	61	46	50	46	41	72,40	FI-T-25/30/25S-W3		
	.98	1.18	.98	5800	1.93	1.46	1.40	1.46	2.40	2.44	2.40	1.81	1.97	1.81	1.61	159,28			
	30	20	30	400	49	35,5	38,5	35,5	62	48	62	50	36	50	41	80,00	FI-T-30/20/30S-W3		
	1.18	.79	1.18	5800	1.93	1.40	1.52	1.40	2.44	1.89	2.44	1.97	1.42	1.97	1.61	176,00			
	38	25	38	400	57	41	45	41	72	69	72	60	46	60	50	134,72	FI-T-38/25/38S-W3		
	1.50	.98	1.50	5800	2.24	1.61	1.77	1.61	2.83	2.72	2.83	2.36	1.81	2.36	1.97	296,38			
	38	30	38	400	57	41	43,5	41	72	70	72	60	50	60	50	125,00	FI-T-38/30/38S-W3		
	1.50	1.18	1.50	5800	2.24	1.61	1.71	1.61	2.83	2.76	2.83	2.36	1.97	2.36	1.97	275,00			

¹ Approximate dimension in assembled condition.

² Weight excluding cutting rings and union nuts.

³ Standard scope of delivery: Fitting body only.