

Gauge Standpipe Fitting
Type FI-EMA-...-R ▪ Series L / S

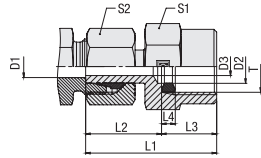

Internal Metallic Sealing Ring

Female Whitworth Parallel Pipe Thread (BSPP)

Series	Tube OD (mm/in)	PN (bar/PSI)	Dimensions (mm/in)	Dimensions										Weight (kg/lbs) Ca. per 100 ¹	Ordering Codes
				Thread T	D2	D3	L1	L2	L3	L4	S1	S2			
L	6	315	G 1/4	5,5	3,3	38	23,5	14,5	4,5	19	14	4,65	FI-EMA-06LR-W3-DKI-SV		
	.24	4568		.22	.13	1.5	.93	.57	.18	.75	.55	10.23			
	8	315	G 1/4	5,5	3,5	38	23,5	14,5	4,5	19	17	5,53	FI-EMA-08LR-W3-DKI-SV		
	.31	4568		.22	.14	1.5	.93	.57	.18	.75	.67	12.16			
	10	315	G 1/4	5,5	3,5	39,5	25	14,5	4,5	19	19	6,40	FI-EMA-10LR-W3-DKI-SV		
	.39	4568		.22	.14	1.56	.98	.57	.18	.75	.75	14.08			
12	315	G 1/4	5,5	3,5	40,5	26	14,5	4,5	19	22	8,01	FI-EMA-12LR-W3-DKI-SV			
.47	4568		.22	.14	1.59	1.02	.57	.18	.75	.87	17.63				
S	6	630	G 1/2	7	3,5	45	25	20	5	27	17	10,73	FI-EMA-06SR-W3-DKI-SV		
	.24	9135		.28	.14	1.77	.98	.79	.2	1.06	.67	23.61			
	8	630	G 1/2	7	3,5	45	25	20	5	27	19	10,95	FI-EMA-08SR-W3-DKI-SV		
	.31	9135		.28	.14	1.77	.98	.79	.2	1.06	.75	24.09			
	10	630	G 1/2	7	3,5	47	27	20	5	27	22	12,15	FI-EMA-10SR-W3-DKI-SV		
	.39	9135		.28	.14	1.85	1.06	.79	.2	1.06	.87	26.73			
12	630	G 1/2	7	3,5	47,5	27,5	20	5	27	24	13,43	FI-EMA-12SR-W3-DKI-SV			
.47	9135		.28	.14	1.87	1.08	.79	.2	1.06	.94	29.55				

¹ Weight including cutting ring and union nut.

Please note: Standpipes are always factory-assembled with cutting rings and union nuts.

The union nut assembled on the standpipe has to be tightened by only 1/12 a turn (equivalent to 30°) beyond the fixed point.



Ordering Codes

***FI-EMA*-10*L*R*-W3*-DKI-SV**

- * Gauge Standpipe Fitting FI-EMA
- * Outside Tube Diameter D1 (in mm) -10
- * Series Light Series L
Heavy Series S
- * Thread Type Female Whitworth Parallel Pipe Thread (BSPP) R
- If required, please indicate special sizes, e.g. R1/2!
- * Material Code Steel, zinc/nickel-plated -W3
- Please contact STAUFF for alternative materials and surface finishings.
- * Internal Seal Type Internal metallic sealing ring -DKI
- * Assembling / Kitting Standpipe factory-assembled with cutting ring and union nut -SV

Spare Parts / Accessories



Internal Metallic Sealing Ring
Type FI-DKI