

Male Stud Branch Tee
Type FI-TE-...-Rk ▪ Series LL / L / S

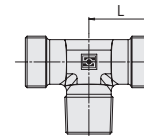
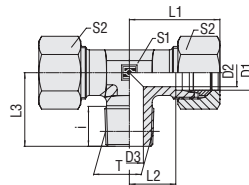

Whitworth Taper Pipe Thread (BSPT)

Ordering Codes

***FI-TE*-10*L*Rk*-W3*-MS**

- * Male Stud Branch Tee **FI-TE**
- * Outside Tube Diameter D1 (in mm) **-10**
- * Series **LL**
 Extra-Light Series **L**
 Light Series **S**
 Heavy Series
- * Thread Type **Rk**
 Whitworth Taper Pipe Thread (BSPT)
- If required, please indicate special sizes, e.g. R1/8k!
- * Material Code **-W3**
 Steel, zinc/nickel-plated
- Please contact STAUFF for alternative materials and surface finishings.
- * Assembling / Kitting **—**
 Fitting body only
- Fitting body supplied with cutting rings and union nuts **-MS**
- Fitting body supplied with soft-sealing cutting rings and union nuts **-MSV**

Series	Tube OD (mm/in)	PN (bar/psi)	Dimensions (mm/in)										Weight (kg/lbs) ca. per 100 ²	Ordering Codes ³
			D1	Thread	T	D2	D3	i	L	L1 ¹	L2	L3		
LL	4	100	R 1/8 keg.	3	4	8	15	21	11	17	9	10	1,59	FI-TE-04LLRk-W3
	.16	1450		.12	.16	.31	.59	.83	.43	.67	.35	.39	3,50	
	6	100	R 1/8 keg.	4,5	4,5	8	15	21	9,5	17	9	12	1,34	FI-TE-06LLRk-W3
	.24	1450		.18	.18	.31	.59	.83	.37	.67	.35	.47	2,94	
L	8	100	R 1/8 keg.	6	6	8	17	23	11,5	20	12	14	1,88	FI-TE-08LLRk-W3
	.31	1450		.24	.24	.31	.67	.91	.45	.79	.47	.55	4,14	
	6	315	R 1/8 keg.	4	4	8	19	27	12	20	12	14	2,73	FI-TE-06LRk-W3
	.24	4568		.16	.16	.31	.75	1.06	.47	.79	.47	.55	6,00	
Rk	8	315	R 1/4 keg.	6	6	12	21	29	14	26	12	17	3,80	FI-TE-08LRk-W3
	.31	4568		.24	.24	.47	.83	1.14	.55	1.02	.47	.67	8,36	
	10	315	R 1/4 keg.	8	7	12	22	30	15	27	14	19	4,70	FI-TE-10LRk-W3
	.39	4568		.31	.28	.47	.87	1.18	.59	1.06	.55	.75	10,34	
S	12	315	R 3/8 keg.	10	9	12	24	32	17	28	17	22	6,28	FI-TE-12LRk-W3
	.47	4568		.39	.35	.47	.94	1.26	.67	1.10	.67	.87	13,82	
	15	315	R 1/2 keg.	12	11	14	28	36	21	34	19	27	11,80	FI-TE-15LRk-W3
	.59	4568		.47	.43	.55	1.10	1.42	.83	1.34	.75	1.06	25,96	
MS	18	315	R 1/2 keg.	15	14	14	31	40	23,5	36	24	32	16,30	FI-TE-18LRk-W3
	.71	4568		.59	.55	.55	1.22	1.57	.93	1.42	.94	1.26	35,86	
	6	400	R 1/4 keg.	4	4	12	23	31	16	26	12	17	5,00	FI-TE-06SRk-W3
	.24	5800		.16	.16	.47	.91	1.22	.63	1.02	.47	.67	11,00	
MSV	8	400	R 1/4 keg.	5	5	12	24	32	17	27	14	19	6,27	FI-TE-08SRk-W3
	.31	5800		.20	.20	.47	.94	1.26	.67	1.06	.55	.75	13,80	
	10	400	R 3/8 keg.	7	7	12	25	34	17,5	28	17	22	8,50	FI-TE-10SRk-W3
	.39	5800		.28	.28	.47	.98	1.34	.69	1.10	.67	.87	18,70	
MSV	12	400	R 3/8 keg.	8	8	12	29	38	21,5	28	17	24	11,60	FI-TE-12SRk-W3
	.47	5800		.31	.31	.47	1.14	1.50	.85	1.10	.67	.94	25,52	
	14	400	R 1/2 keg.	10	10	14	30	40	22	32	19	27	15,47	FI-TE-14SRk-W3
	.55	5800		.39	.39	.55	1.18	1.57	.87	1.26	.75	1.06	34,03	
MSV	16	400	R 1/2 keg.	12	12	14	33	43	24,5	32	24	30	18,90	FI-TE-16SRk-W3
	.63	5800		.47	.47	.55	1.30	1.69	.96	1.26	.94	1.18	41,58	

Connecting Parts

- Cutting Ring
Type **FI-DS**
- Soft-Sealing Cutting Ring
Type **FI-WDDS**
- Support Sleeve
Type **FI-VH**
- STAUFF Form Ring
Type **FI-AR**
- Union Nut
Type **FI-M**
- 37° Flared Tube Fitting Set
Type **FI-AB**

¹ Approximate dimension in assembled condition.
² Weight excluding cutting rings and union nuts.
³ Standard scope of delivery: Fitting body only.

Male stud acc. to DIN 3852-2 (Form C)
 Port acc. to DIN 3852-2 (Form Z)

Suitable liquid / plastic sealant required.

Male threaded studs were designed for female threaded ports in components made of steel. For applications with components made of softer mating materials (e.g. Aluminium), the use of connectors with additionally rolled male threads is recommended.
 Please contact STAUFF prior to the assembly for further information.