

24° Weld Cone Reducer with O-Ring Type FI-SNR ▪ Series L / S

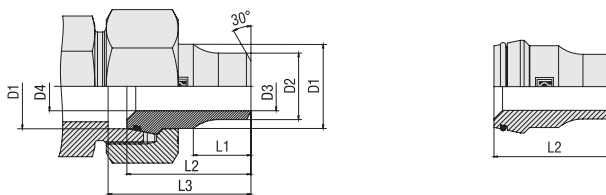

Ordering Codes

FI-SNR-10/*08*x2.5*-B*-W2

- * 24° Weld Cone Reducer with O-Ring **FI-SNR**
- * Outside Tube Diameter D1 (in mm) **-10/**
- * Outside Tube Diameter D2 (in mm) **-08**
- * Wall Thickness (in mm) **x2.5**
- * Seal Material NBR (Buna-N®) **-B**
FKM (Viton®) **-V**
EPDM **-E**
- * Material Code Steel, phosphated **-W2**

Please contact STAUFF for alternative materials and surface finishings.

FI-SNR-10*L*08*x2.5*-B*-W159*-M

- * 24° Weld Cone Reducer with O-Ring **FI-SNR**
- * Outside Tube Diameter D1 (in mm) **-10**
- * Series Light Series **L**
Heavy Series **S**
- * Outside Tube Diameter D2 (in mm) **-08**
- * Wall Thickness (in mm) **x2.5**
- * Seal Material NBR (Buna-N®) **-B**
FKM (Viton®) **-V**
EPDM **-E**
- * Material Code Weld cone:
Steel, phosphated **-W159**
Union nut:
Steel, zinc/nickel-plated

Please contact STAUFF for alternative materials and surface finishings.

- * Assembling / Kitting 24° weld cone with O-ring supplied with union nut **-M**

Series	Tube OD		PN (bar/psi)	Dimensions (mm/in)						Weight (kg/lbs) ca. per 100 ²	Ordering Codes ³
	D1	for Tube		D2	D3	D4	L1	L2	L3		
L/S	8	6 x 2,0	400	6	2	5	12	31	32	1,45	FI-SNR-08/06x2.0-B-W2
	.31	.24 x .08	5800	.24	.08	.20	.47	1.22	1.26	3.19	
	10	8 x 2,5	400	8	3	6,50	12	32,5	33,5	1,75	FI-SNR-10/08x2.5-B-W2
	.39	.31 x .10	5800	.31	.12	.26	.47	1.28	1.32	3.85	
	12	10 x 3,0	400	10	4	8	14	32,5	33,5	2,19	FI-SNR-12/10x3.0-B-W2
.47	.39 x .12	5800	.39	.16	.31	.55	1.28	1.32	4.82		
S	14	12 x 3,5	400	12	5	9	15	38,5	39,5	3,56	FI-SNR-14/12x3.5-B-W2
	.55	.47 x .14	5800	.47	.20	.35	.59	1.52	1.56	7.83	
	16	12 x 2,0	250	12	8	11	17	38,5	41	4,70	FI-SNR-16/12x2.0-B-W2
	.63	.47 x .08	3625	.47	.31	.43	.67	1.52	1.61	10.34	
	20	16 x 3,0	315	16	10	14	17	44,5	47	7,73	FI-SNR-20/16x3.0-B-W2
	.79	.63 x .12	4568	.63	.39	.55	.67	1.75	1.85	17.01	
	30	25 x 5,0	315	25	15	22	22	52	57,5	16,91	FI-SNR-30/25x5.0-B-W2
	1.18	.98 x .20	4568	.98	.59	.87	.87	2.05	2.26	37.21	

¹ Approximate dimension in assembled condition.

² Weight excluding union nut.

³ Standard scope of delivery: 24° weld cone and O-ring.

Standard seal material is NBR (Buna-N®).

Connecting Parts



Union Nut
Type **FI-M**

Spare Parts / Accessories



O-Ring
Type **O-RING**