

Support Sleeve
Type FI-VH

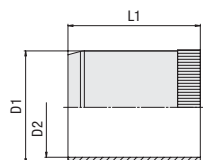

Ordering Codes

***FI-VH*-10*x1.5*-W69**

- * Support Sleeve **FI-VH**
- * Outside Tube Diameter (in mm) **-10**
- * Wall Thickness (in mm) **x1.5**
- * Material Code Brass **-W69**

Please contact STAUFF for alternative materials and surface finishings.

Dimensions (mm/in)	Dimensions			Ordering Codes
	for Tube	D1	D2	
6 x 1	4	2,6	15,5	FI-VH-06x1-W69
.24 x .04	.16	.10	.61	
6 x 0,75	4,5	3,1	12,5	FI-VH-06x0.75-W69
.24 x .03	.18	.12	.49	
6 x 0,5	5	3,6	12,5	FI-VH-06x0.5-W69
.24 x .02	.20	.14	.49	
8 x 1	6	4,6	15,5	FI-VH-08x1-W69
.31 x .04	.24	.18	.61	
8 x 0,75	6,5	5,1	12,5	FI-VH-08x0.75-W69
.31 x .03	.26	.20	.49	
10 x 1,5	7	5,6	17	FI-VH-10x1.5-W69
.39 x .06	.28	.22	.67	
10 x 1	8	6,6	16,5	FI-VH-10x1-W69
.39 x .04	.31	.26	.65	
10 x 0,75	8,5	7,1	16,5	FI-VH-10x0.75-W69
.39 x .03	.33	.28	.65	
12 x 1,5	9	7,6	16,5	FI-VH-12x1.5-W69
.47 x .06	.35	.30	.65	
12 x 1	10	8,6	16,5	FI-VH-12x1-W69
.47 x .04	.39	.34	.65	
12 x 0,75	10,5	9,3	16,5	FI-VH-12x0.75-W69
.47 x .03	.41	.37	.65	
14 x 1	12	10,2	18	FI-VH-14x1-W69
.55 x .04	.47	.40	.71	
15 x 1,5	12	10,2	17	FI-VH-15x1.5-W69
.59 x .06	.47	.40	.67	
15 x 1	13	11,2	17	FI-VH-15x1-W69
.59 x .04	.51	.44	.67	
18 x 1,5	15	13,2	17,5	FI-VH-18x1.5-W69
.71 x .06	.59	.52	.69	
18 x 1	16	14,2	17,5	FI-VH-18x1-W69
.71 x .04	.63	.56	.69	
20 x 1	18	16,2	22	FI-VH-20x1-W69
.79 x .04	.71	.64	.87	
22 x 1,5	19	17,2	18	FI-VH-22x1.5-W69
.87 x .06	.75	.68	.71	
22 x 1	20	18,2	18	FI-VH-22x1-W69
.87 x .04	.79	.72	.71	
25 x 1,5	22	20,2	23,5	FI-VH-25x1.5-W69
.98 x .06	.87	.80	.93	
25 x 1	23	21,2	23,5	FI-VH-25x1-W69
.98 x .04	.91	.83	.93	
28 x 2	24	22,2	23,5	FI-VH-28x2-W69
1.10 x .08	.94	.87	.93	
28 x 1,5	25	23,2	23,5	FI-VH-28x1.5-W69
1.10 x .06	.98	.91	.93	
28 x 1	26	24,2	23,5	FI-VH-28x1-W69
1.10 x .04	1.02	.95	.93	
35 x 2	31	28,8	23,5	FI-VH-35x2-W69
1.38 x .08	1.22	1.13	.93	
35 x 1,5	32	29,8	23,5	FI-VH-35x1.5-W69
1.38 x .06	1.26	1.17	.93	
35 x 1	33	30,8	23,5	FI-VH-35x1-W69
1.38 x .04	1.30	1.21	.93	
42 x 2	38	35,8	23,5	FI-VH-42x2-W69
1.65 x .08	1.50	1.41	.93	
42 x 1,5	39	36,8	23,5	FI-VH-42x1.5-W69
1.65 x .06	1.54	1.45	.93	