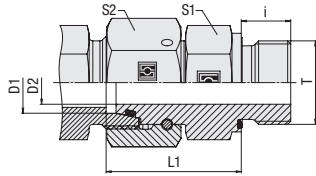

**Straight Male Stud Fitting with 24° Taper / O-Ring
Type FI-EGED-...-M-WD • Series L / S**

Profile Sealing Ring
Metric Parallel Thread

Series	Tube OD (mm/in)	PN (bar/PSI)	Dimensions (mm/in)						Torque (N·m/ft-lb)	Weight (kg/lbs) ca.	Ordering Codes
			Thread T	D2	i	L1	S1	S2			
L	6	500	M10x1	2,5	8	24,5	14	14	18	3,76	FI-EGED-06LM-WD-B-W3-DKO
	.24	7250		.10	.31	.96	.55	.55	13.3	8.27	
	8	500	M12x1,5	4	12	26,5	17	17	25	4,64	FI-EGED-08LM-WD-B-W3-DKO
	.31	7250		.16	.47	1.04	.67	.67	18.5	10.21	
	10	500	M14x1,5	6	12	27,5	19	19	45	5,97	FI-EGED-10LM-WD-B-W3-DKO
	.39	7250		.24	.47	1.08	.75	.75	33.3	13.14	
	12	400	M16x1,5	8	12	30,5	22	22	55	9,58	FI-EGED-12LM-WD-B-W3-DKO
	.47	5800		.31	.47	1.20	.87	.87	40.7	21.08	
	15	400	M18x1,5	10	12	31,5	24	27	70	12,62	FI-EGED-15LM-WD-B-W3-DKO
	.59	5800		.39	.47	1.24	.94	1.06	51.8	27.76	
	18	400	M22x1,5	13	14	31,5	27	32	125	15,28	FI-EGED-18LM-WD-B-W3-DKO
	.71	5800		.51	.55	1.24	1.06	1.26	92.5	33.62	
	22	250	M26x1,5	17	16	32,5	32	36	180	20,75	FI-EGED-22LM-WD-B-W3-DKO
	.87	3625		.67	.63	1.28	1.26	1.42	133.2	45.64	
	28	250	M33x2	22	18	35	41	41	310	28,61	FI-EGED-28LM-WD-B-W3-DKO
	1.10	3625		.87	.71	1.38	1.61	1.61	229.4	62.95	
	35	250	M42x2	28	20	42,5	50	50	450	52,30	FI-EGED-35LM-WD-B-W3-DKO
	1.38	3625		1.10	.79	1.67	1.97	1.97	333.0	115.06	
42	250	M48x2	34	22	46,5	55	60	540	72,56	FI-EGED-42LM-WD-B-W3-DKO	
1.65	3625		1.34	.87	1.83	2.17	2.36	399.6	159.62		
S	6	800	M12x1,5	2,5	12	27	17	17	35	4,88	FI-EGED-06SM-WD-B-W3-DKO
	.24	11600		.10	.47	1.06	.67	.67	25.9	10.73	
	8	800	M14x1,5	4	12	29,5	19	19	55	6,59	FI-EGED-08SM-WD-B-W3-DKO
	.31	11600		.16	.47	1.16	.75	.75	40.7	14.49	
	10	800	M16x1,5	6	12	32	22	22	70	9,34	FI-EGED-10SM-WD-B-W3-DKO
	.39	11600		.24	.47	1.26	.87	.87	51.80	20.54	
	12	630	M18x1,5	8	12	34	24	24	90	10,44	FI-EGED-12SM-WD-B-W3-DKO
	.47	9135		.31	.47	1.34	.94	.94	66.6	22.97	
	14	630	M20x1,5	9	14	36,5	27	27	125	16,00	FI-EGED-14SM-WD-B-W3-DKO
	.55	9135		.35	.55	1.44	1.06	1.06	92.5	35.21	
	16	630	M22x1,5	11	14	37	27	30	135	17,32	FI-EGED-16SM-WD-B-W3-DKO
	.63	9135		.43	.55	1.46	1.06	1.18	99.9	38.11	
	20	400	M27x2	14	16	43	32	36	180	27,99	FI-EGED-20SM-WD-B-W3-DKO
	.79	5800		.55	.63	1.69	1.26	1.42	133.2	61.58	
	25	400	M33x2	18	18	48	41	46	310	50,00	FI-EGED-25SM-WD-B-W3-DKO
	.98	5800		.71	.71	1.89	1.61	1.81	229.4	110.00	
	30	400	M42x2	23	20	51	50	50	450	70,30	FI-EGED-30SM-WD-B-W3-DKO
	1.18	5800		.91	.79	2.01	1.97	1.97	333.0	154.66	
38	400	M48x2	30	22	60	55	60	540	94,50	FI-EGED-38SM-WD-B-W3-DKO	
1.50	5800		1.18	.87	2.36	2.17	2.36	399.6	207.90		

Ordering Codes
***FI-EGED*-10*L*M*-WD*-B*-W3*-DKO**

* Straight Male Stud Fitting with 24° Taper / O-Ring (DKO) **FI-EGED**

* Outside Tube Diameter D1 (in mm) **-10**

* Series Light Series **L**
Heavy Series **S**

* Thread Type Metric Parallel Thread **M**

If required, please indicate special sizes, e.g. M12x1.5!

* Seal Type Profile Sealing Ring **-WD**

* Seal Material NBR (Buna-N®) **-B**
FKM (Viton®) **-V**
Male Stud: NBR (Buna-N®) **-BV**
24° Taper: FKM (Viton®) **-E**
EPDM **-E**

* Material Code Steel, zinc/nickel-plated **-W3**

Please contact STAUFF for alternative materials and surface finishings.

* Assembling / Kitting Fitting body supplied with swivel nut and O-ring **-DKO**

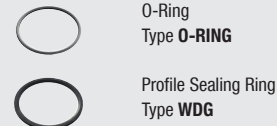
Spare Parts / Accessories

Standard seal material is NBR (Buna-N®).

Male threaded studs were designed for female threaded ports in components made of steel. For applications with components made of softer mating materials (e.g. Aluminium), the use of connectors with additionally rolled male threads is recommended.

Please contact STAUFF prior to the assembly for further information.

Male stud acc. to ISO 9974-2 (Type E)

Port acc. to ISO 9974-1

Torque recommendations for Steel mating material.